



Powering Everything with Renewable Energy

**Power Your Business
Increase ROI
Lead with Clean Energy**



93Energy is a national renewable energy developer and EPC (Engineering, Procurement, and Construction) firm headquartered in the Chicagoland area. For more than seven years, we have partnered with organizations across industries to design, engineer, and build clean energy projects that reduce costs and drive long-term value. Our diverse client base includes manufacturers, private educational institutions, and public sector and governmental organizations.





Our Commercial Energy Services

Solar EPC
Contractor

Energy
Storage

Project
Development

EV
Charging

Operations &
Maintenance



Solar EPC Contractor

Full System Design

Engineering and Permitting

Procurement

Installation

Roof Mount

Ground Mount

Carport

Utility Interconnection

Energy Modeling



Energy Storage

Asset Management

Load Shedding

Revenue Optimization

Utility Rate Analysis

Frequency Regulation

Financial Modeling

Demand Reduction



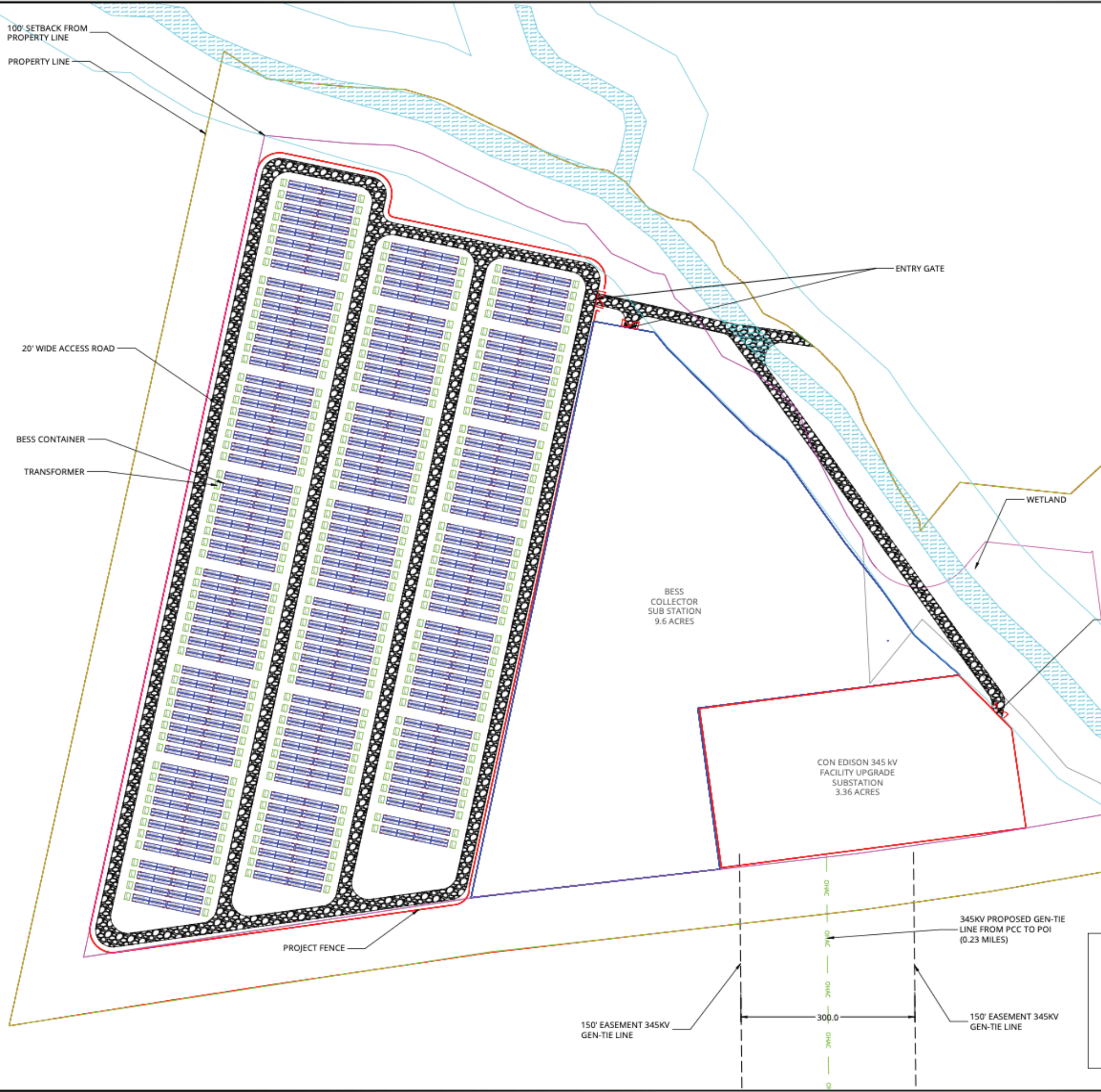

Project Development

System Design and Optimization

Interconnection Application and Coordination

Incentive Coordination and Compliance

Engineering

Federal, State, And Local Permitting

Labor Sourcing

Procurement

Financing Options

SYSTEM DESCRIPTION		
AC SYSTEM SIZE	1000	MWac
BESS DISCHARGING DURATION	4	Hours
AC SYSTEM SIZE	4000	MWh
PROJECT LOCATION (LAT/LONG)	*	
PCC/POI VOLTAGE	345	kV
UTILITY	NYSEG	
BESS MAKE	TESLA	
BESS RATING	MEGAPACK 2 XL	
BESS RATING (INBUILT TO BATTERY CONTAINER)	979 kW / 3916 kWh	
PCS RATING (INBUILT TO BATTERY CONTAINER)	1280	#
PCS RATING (INBUILT TO BATTERY CONTAINER)	979 kW / 1000 kVA	

PARCEL DETAILS		
PARCEL OWNER		
PARCEL APN NO.		
TOTAL PARCEL AREA	144.96	ACRES
TOTAL BESS PROJECT AREA	50.00	ACRES
TOTAL BESS FENCE AREA	18.71	ACRES
PROPOSED SUBSTATION FENCE	3136	LF
FACILITY UPGRADE AREA	3.36	ACRES
WETLAND AREA	2.7	ACRES
FLOODLAND AREA	0.0	ACRES

EQUIPMENT		
		DESCRIPTION
		PROPERTY BOUNDARY
		ACCESS ROAD
		FLOOD LAND
		WET LAND
		BESS FENCE
		CON EDISON SUB STATION FENCE
		BATTERY CONTAINER
		MV TRANSFORMER
		ACCESS GATE
		PROPOSED GEN-TIE LINE
		EXISTING TRANSMISSION LINE

REVISIONS		
REV	DESCRIPTION	DATE
R3	10% DESIGN	24-12-20
R2	INITIAL LAYOUT	24-11-20
R1	10% DESIGN	24-10-25
R0	10% DESIGN	24-09-03

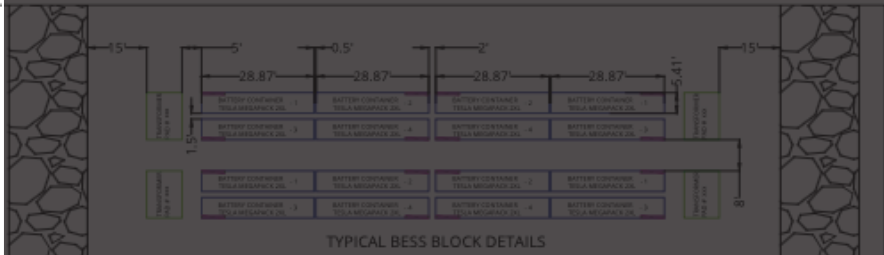

PRELIMINARY, NOT FOR CONSTRUCTION

DEVELOPER		
93ENERGY		
ENGINEER		
EPC CONTRACTOR		
SEAL		
PROJECT INFORMATION		
DATE	BY	DESCRIPTION
24-12-20	AK	10% DESIGN
24-11-20	TM	INITIAL LAYOUT
24-10-25	AD	10% DESIGN
24-09-03	ZGP	10% DESIGN
24-09-03	AKP	10% DESIGN
24-09-03	NI	10% DESIGN
PROJECT TITLE		
SCALE		
1" = 7'		
PROJECT NO		
DRAWING TITLE		
ELECTRICAL ARRAY LAYOUT		
DRAWING NO		
E102		



EV Charging

Assessment of Electrical
System Compatibility

Review of System Requirements
and Local Incentives

Solar Canopy Design and Install

Improved Fleet Management

Assessment of Grid Capacity





Operations & Maintenance

Software Monitoring

Annual Inspections

Thermal Imaging

Labor Compliance

Landscape Maintenance

Security





Featured Projects



Heavy Mfg: 527kW DC



Light Mfg: 191kW DC



Self Storage: 4MW DC



Industrial: 3MW AC



Public Works: 260kW DC



Education: 695kW DC



Gov Facility: 700kW DC



Net Zero Aff Housing: 200kW



Retail: 2.8MW DC



Hospital Carport: 500kW DC

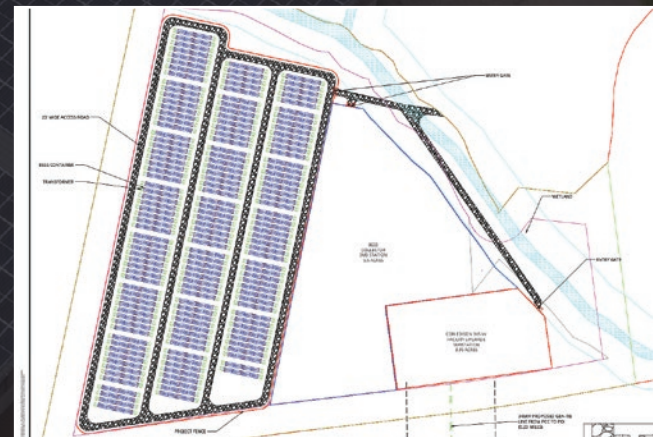

Utility Scale BESS 1GW AC



Utility Scale Solar: 150MW AC

Meet Our Team

Eric Payne

Founder & Co-CEO
epayne@93energy.com

Dave Karnes

Co-CEO
dkarnes@93energy.com

Rob Zaldivar

Chief Estimating & Policy Officer
rzaldivar@93energy.com

Mark Brouwer

Chief Construction Officer
mbrouwer@93energy.com

Nick Braccini

General Foreman
nbraccini@93energy.com

Mitch Perrotta

Foreman
mperrotta@93energy.com

Vinh Diep

Pre-Construction Project Manager
vdiep@93energy.com

Chelly Engel

Payroll & Administration
cengel@93energy.com





93Energy = People + Planet + Profit

Turning Sunlight's Journey into Lasting Energy Infrastructure

www.93energy.com